

K62G
 Ser. No. 0000001-Current
 Rev. 6-18-07

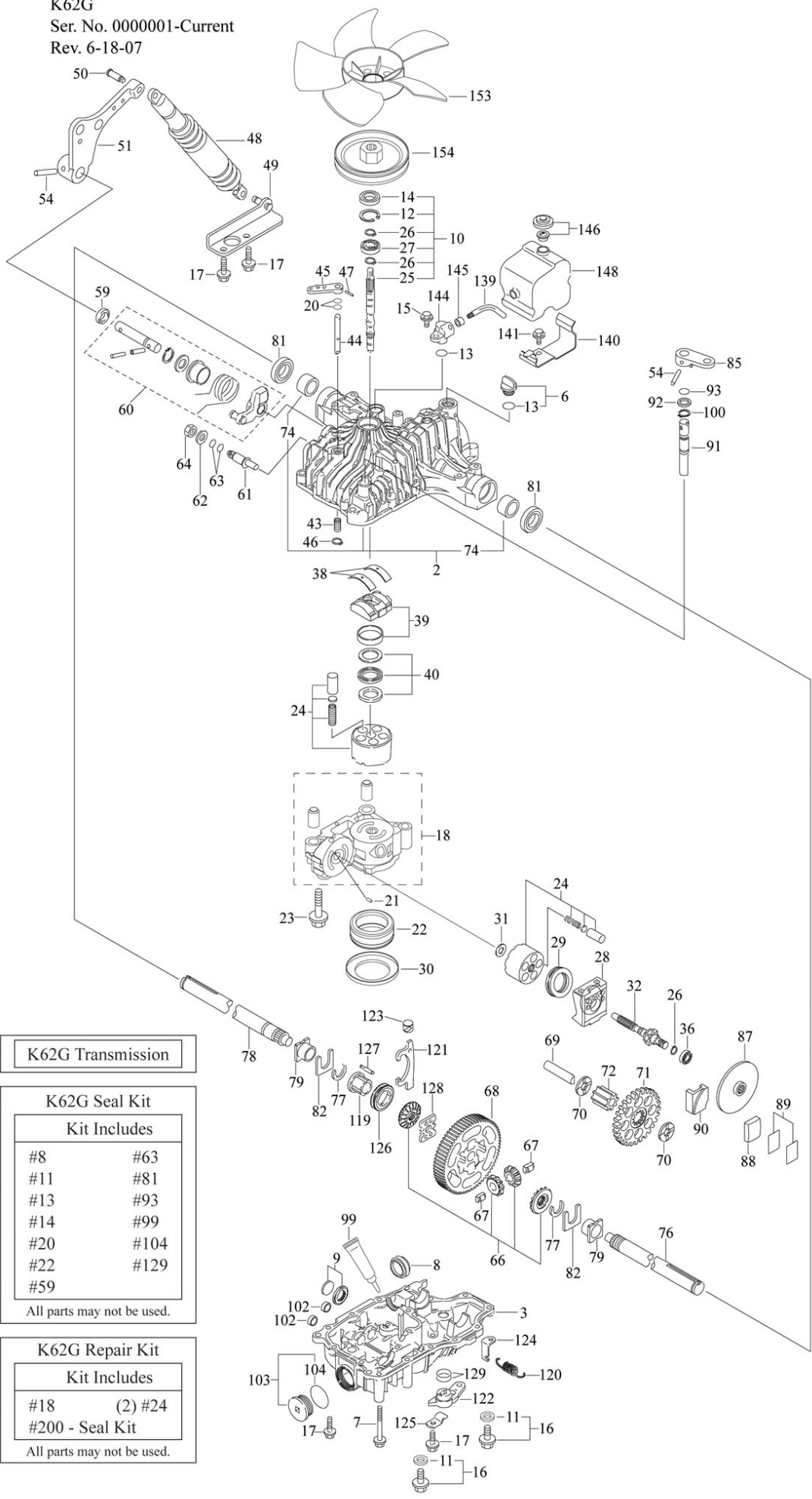

- 1 K62G Transmission
- 200

| K62G Seal Kit | |
|---------------|------|
| Kit Includes | |
| #8 | #63 |
| #11 | #81 |
| #13 | #93 |
| #14 | #99 |
| #20 | #104 |
| #22 | #129 |
| #59 | |

All parts may not be used.
- 201

| K62G Repair Kit | |
|-----------------|------------|
| Kit Includes | |
| #18 | (2) #24 |
| #200 | - Seal Kit |

All parts may not be used.

K62G (7A632084030) Countax

| <u>ID Number</u> | <u>TTC Part No.</u> | <u>Part Description</u> |
|------------------|---------------------|-------------------------|
| 1 | 7A632084030 | K62G TRANSAXLE |
| 2 | 1A632024101 | UPPER CASE KIT |
| 3 | 1A632084160 | LOWER CASE |
| 6 | 19485524290 | OIL CAP 20, PLASTIC |
| 7 | 19215424310 | CAP SCREW 8 * 75 |
| 8 | 1A632024320 | FILTER |
| 9 | 19216324350 | MAGNET |
| 10 | 1A632099200 | PUMP SHAFT/BEARING KIT |
| 11 | 22190100000 | SEAL WASHER 10 |
| 12 | 22252000350 | SNAP RING C 35 |
| 13 | 24311000180 | O-RING P18 |
| 14 | 24421153507 | SEAL TC 153507 |
| 15 | 26106080202 | BOLT 8 * 20 |
| 16 | 26106100122 | BOLT 10 * 12 |
| 17 | 26476080302 | TAPPING SCREW 8 * 30 |
| 18 | 1A632024500 | CENTER CASE A |
| 20 | 24311240100 | O-RING 1A P10A |
| 21 | 19216824760 | PIN 3 * 9.8 |
| 22 | 19215488211 | FILTER |
| 23 | 26106100652 | BOLT 10 * 65 |
| 24 | 19216825210 | CYLINDER BLOCK KIT |
| 26 | 19215425310 | SNAP RING S15 |
| 27 | 24101062020 | BEARING 6202C3 |
| 28 | 1A632024210 | MOTOR HOUSING |
| 29 | 19215424240 | THRUST BEARING |
| 30 | 1A632024980 | FILTER CAP |
| 31 | 19216825230 | WASHER 12 * 24 * 1 |
| 32 | 1A632085280 | MOTOR SHAFT/GEAR (10T) |
| 36 | 24102063020 | BEARING 6302DUC3 |
| 38 | 19215427051 | THRUST METAL |
| 39 | 1A632027100 | SWASH PLATE ASSEMBLY |
| 40 | New Part # | THRUST BEARING KIT |
| 43 | 19215427281 | SPRING 25 |
| 44 | 1A632029510 | BYPASS SHAFT |
| 45 | 1A632029520 | BYPASS LEVER |
| 46 | 19216829570 | SNAP RING 10 |
| 47 | 22351030020 | SPRING PIN 3.0A * 20 |
| 48 | 19215489150 | SHOCK ABSORBER K65 |
| 49 | 1A632029630 | SHOCKSTAY |
| 50 | 1A632029640 | PIN |
| 51 | 1A632029650 | CONTROL LEVER |
| 54 | 22351060040 | ROLL PIN 6 * 40 |
| 59 | 19406527270 | SEAL TC 162606 |
| 60 | 1A632029801 | CONTROL SHAFT KIT |
| 61 | 1A632029700 | FULCRUM |
| 62 | 22137120000 | WASHER 12 |
| 63 | 24311000140 | O-RING 1A P14 |

| | | |
|-----|------------------|-------------------------|
| 64 | 26776120002 | NUT 12 |
| 66 | 1A632081510 | DIFFERENTIAL GEAR KIT |
| 67 | 1A632081810 | DIFFERENTIAL PINION PIN |
| 68 | 1A632083540 | FINAL GEAR (67T) |
| 69 | 1A632033410 | FINAL PINION SHAFT |
| 70 | 1A632033420 | WASHER 15 * 35 * 3.2 |
| 71 | 1A632083680 | REDUCTION GEAR (55T) |
| 72 | 1A632083560 | FINAL PINION GEAR (11T) |
| 74 | 19215434240 | BUSHING 25.4 |
| 76 | 1A632089111 | AXLE SHAFT, LEFT |
| 77 | 19216734160 | RETAINING RING 23 |
| 78 | 1A632089211 | AXLE SHAFT, RIGHT |
| 79 | 19216734240 | BUSHING |
| 81 | 19215434270 | SEAL S25.4 * 42 * 8 |
| 82 | 1A632034290 | THRUST WASHER |
| 85 | 1A632029870 | BRAKE LEVER |
| 87 | 1A632036110 | BRAKE DISC |
| 88 | 1A632036120 | BRAKE SHOE |
| 89 | 1A632036170 | SHIM KIT |
| 90 | 1A632036201 | BRAKE ACTUATOR |
| 91 | 1A632036160 | BRAKE SHAFT |
| 92 | 1A632036190 | WASHER 16 * 23 * 1.6 |
| 93 | 24311000120 | O-RING 1A P12 |
| 99 | Part of seal kit | SEALANT |
| 100 | 22242000160 | SNAP RING |
| 102 | 1A637024350 | PLUG 20 |
| 103 | 1A637024380 | CAP 40 |
| 104 | 24351020400 | O-RING 1A2040 |
| 119 | 1A632084271 | DIFF-LOCK COLLAR 25.4 |
| 120 | 19215333130 | DIFF-LOCK RETURN SPRING |
| 121 | 1A632087120 | DIFF-LOCK FORK |
| 122 | 1A632087151 | DIFF-LOCK LEVER |
| 123 | 1A632087160 | DIFF-LOCK LEVER PIVOT |
| 124 | 1A632087170 | SPRING HOOK |
| 125 | 1A632087180 | LEVER CLIP |
| 126 | 1A632087260 | DIFF-LOCK SLIDER |
| 127 | 1A632087220 | DIFF-LOCK PIN 7 |
| 128 | 1A632087230 | DIFF-LOCK PLATE 7 |
| 129 | 24321000250 | O-RING 1AG25 |
| 139 | 1A632084940 | PIPE |
| 140 | 1A632084951 | TANK BRACKET |
| 141 | 26476080202 | TAPPING SCREW 8 * 20 |
| 144 | 1A632084040 | FITTING |
| 145 | 1A632084960 | SEAL |
| 146 | 1A632024250 | VENT VALVE 15 |
| 148 | 1A632084930 | RESERVOIR TANK |
| 153 | 19215489071 | FAN 9.0 CCW W/ 25.4 HEX |
| 200 | 1A632099300 | SEAL KIT |
| 201 | 1A632099180 | REPAIR KIT |